



**Flat, 90 Gatcombe Road, Hartcliffe, Bristol, BS13
9RG**

£850 per month
Unfurnished

Flat, 90 Gatcombe Road, Hartcliffe, Bristol, BS13 9RG

This well-maintained home is available December 2025 and is offered unfurnished. Perfect for a single professional or couple, it's conveniently located close to local amenities and transport links, providing easy access to the surrounding area.

To the entrance of the property is a hallway with convenient storage. You'll find an open plan reception/kitchen area with:

- washing machine
- fridge/freezer
- gas hob
- oven.

Through the property, you will find a spacious double bedroom, which leads to the bathroom. The bathroom has a shower/bath.

Outside space is offered via a front communal garden, with a parking space available.

Council Tax Band: A
Holding Deposit: £207
Security Deposit: £1,038

Council Tax Band: A

- Unfurnished
-

GROUND FLOOR

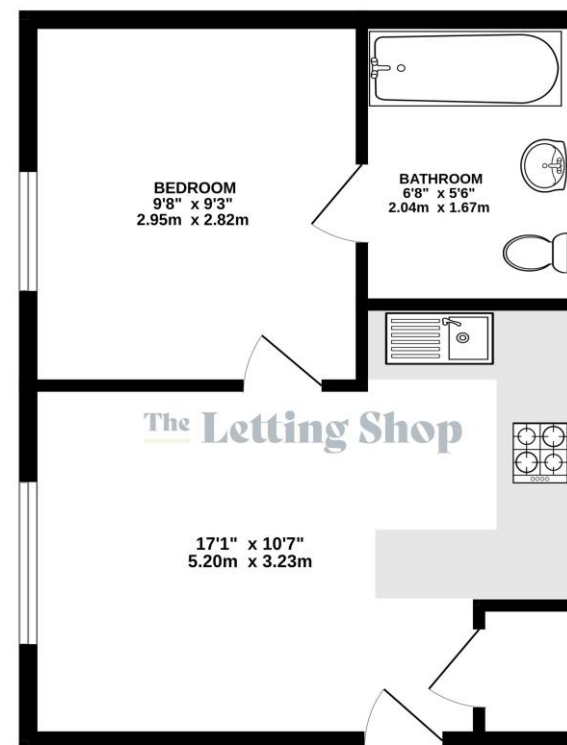

THE LETTING SHOP

Whilst every attempt has been made to ensure the accuracy of the floorplan contained here, measurements of doors, windows, rooms and any other items are approximate and no responsibility is taken for any error, omission or mis-statement. This plan is for illustrative purposes only and should be used as such by any prospective purchaser. The services, systems and appliances shown have not been tested and no guarantee as to their operability or efficiency can be given.
Made with Metropix ©2025





Score	Energy rating	Current	Potential
92+	A		
81-91	B		
69-80	C	73 C	77 C
55-68	D		
39-54	E		
21-38	F		
1-20	G		

The Letting Shop - Bristol

385 Two Mile Hill Road
Kingswood
Bristol
BS15 1AD

T: 0117 9610011

E: hello@lettingshop.com

www.lettingshop.com

United Lettings Limited - Company registration: 03714318 (England and Wales)
Registered Office: 385 Two Mile Hill Road, Kingswood, Bristol, BS15 1AD.

Disclaimer

Every attempt has been made to ensure accuracy, however these property particulars are approximate and for illustrative purposes only. They have been prepared in good faith and they are not intended to constitute part of an offer of contract. We have not carried out a structural survey and the services, appliances and specific fittings have not been tested. All photographs, measurements, floor plans and distances referred to are given as a guide only and should not be relied upon for the purchase of any fixture or fittings. Lease details, service charges and ground rent (where applicable) are given as a guide only and should be checked prior to agreeing a sale.